

SHYAM ICONIC

A Project By



SITE ADDRESS

Sr. No: 26, Shri Shri Ravishankar Marg
Wadala Shiwar, Nashik.

BOOKING CONTACT

+91 9921803310
+91 9921918681



Note :

The contents of this brochure are purely conceptual & no legal bindings on us. developers reserve the right to amend the layout plans, number of floors & unit, elevation, colour scheme, specifications & amenities.

Design By : Panash Design Studio
Contact : 788 822 2885

SHYAM ICONIC

A Project By



ICONIC DESIGN

There is only way to lead
a better and
Dignified life when it
comes to enriching it
With a more comfort
and luxury. Improve
Your outlook on life.
Welcome to 'Shyam
Iconic' it offers a
beautiful urban atmos-
phere with lush and
fabulous ambience.
One of the finest
addresses in Nashik .
Lifestyle that is part of
this extraordinary place.

Project Highlights:

7 Storey Tower

3BHK Spacious Flats

Centrally Located

Alloted Parking Space

Terrace Garden





BASEMENT FLOOR PLAN

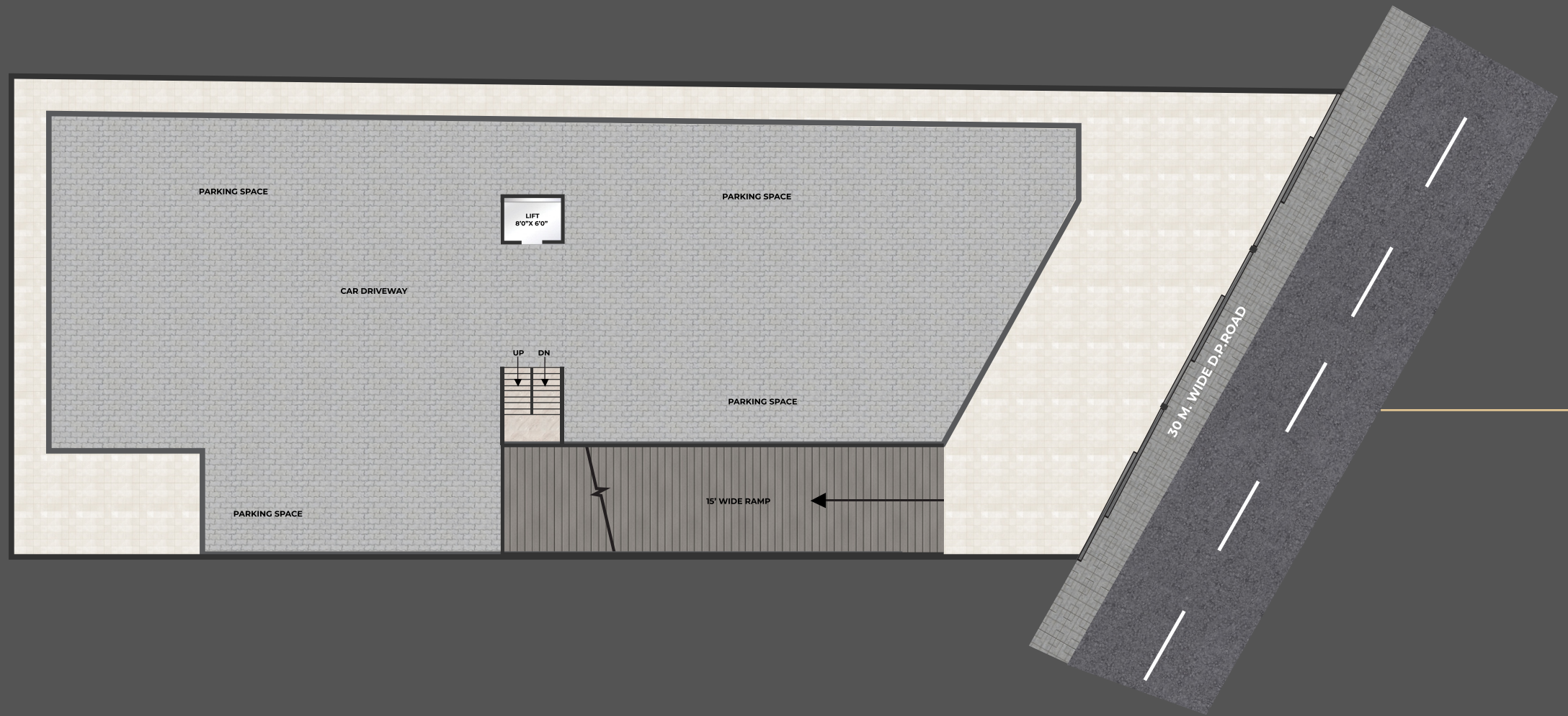

GROUND FLOOR PLAN



ICONIC FLOOR PLAN



FIRST FLOOR PLAN

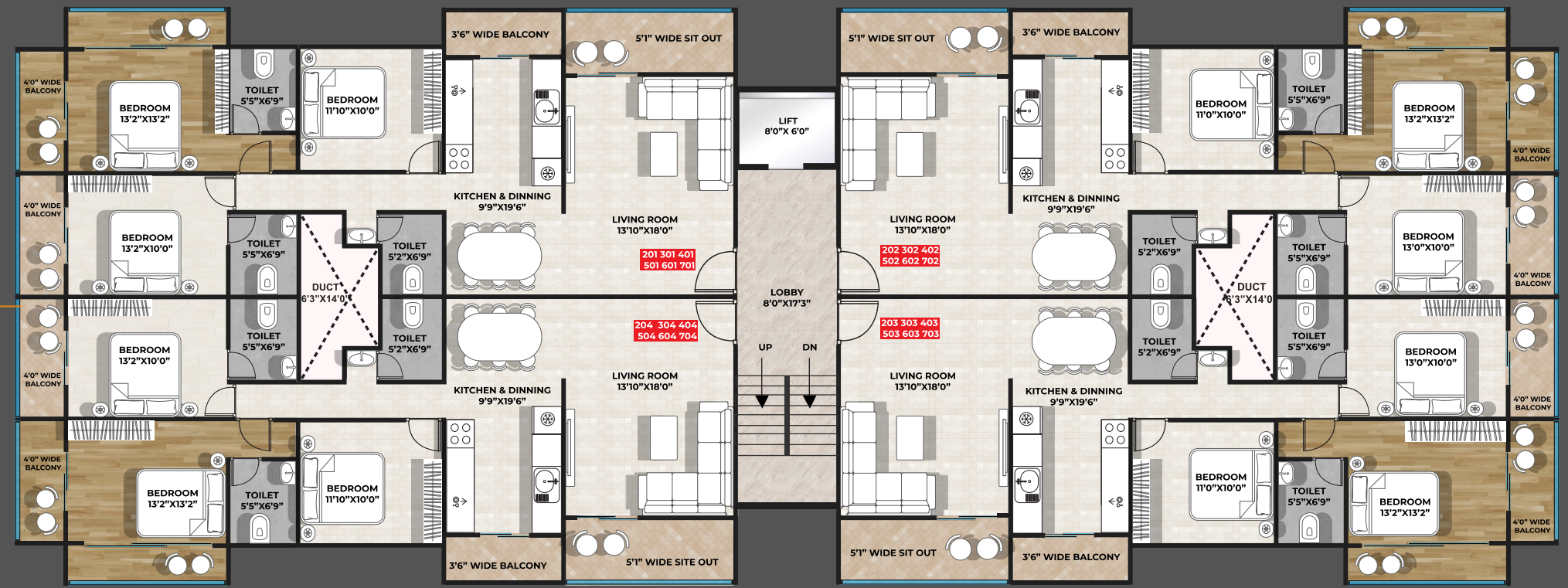

TYPICAL FLOOR PLAN

ICONIC FLOOR PLAN

ICONIC CUT VIEW

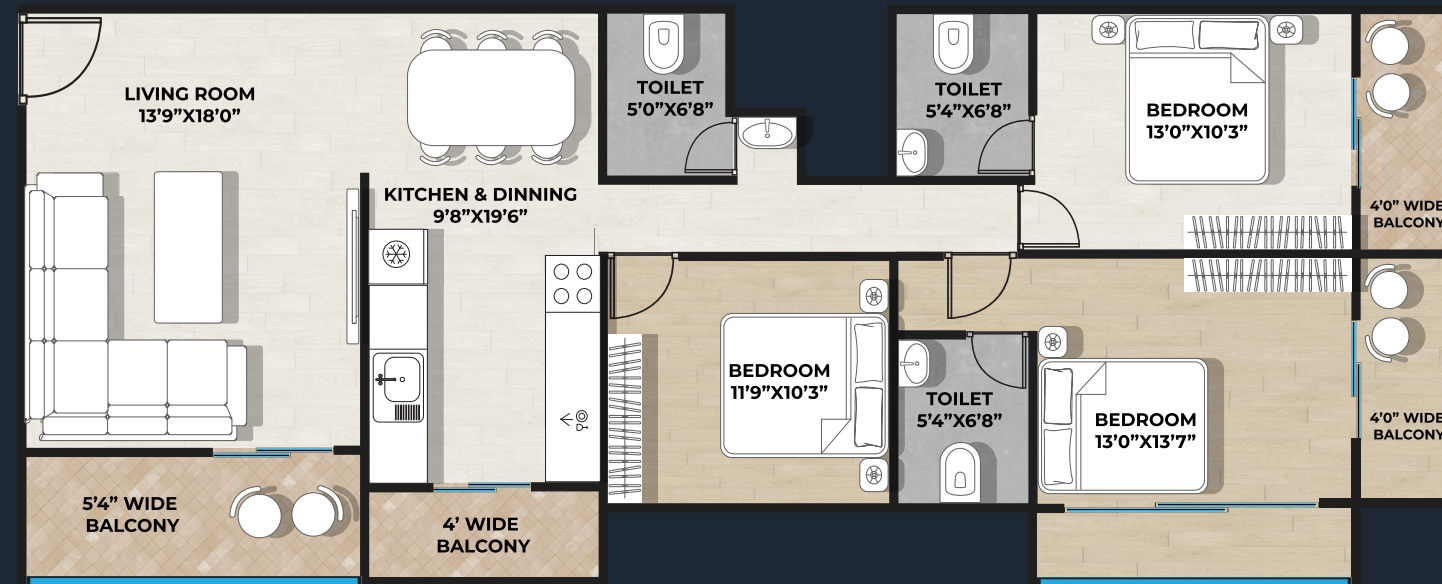

SHYAM ICONIC

ICONIC ELEVATION



Artist's Impression



YOUR HOME IS A REFLECTION
OF WHO YOU ARE.
LET IT SHINE,
JUST LIKE YOU



LOCATION MAP

SPECIFICATIONS



SCHOOL

RYAN INTERNATIONAL SCHOOL
 KK WAGH UNIVERSAL SCHOOL & COLLEGE
 ASHOKA UNIVERSAL SCHOOL
 SACRED HEART CONVENT HIGH SCHOOL

BANK

SBI
 PUNJAB SINDH BANK
 INDIAN BANK
 AXIS BANK
 BANK OF MAHARASHTRA

HOSPITAL

PIONEER HOSPITAL
 SUVICHAR HOSPITAL
 ASHOKA MEDICOVERT HOSPITAL
 GALAXY HOSPITAL

ENTERTAINMENT

D MART
 INOX THEATURE
 PLAYERS FIELD
 VANDE MATARAM PRATISHTAN
 CROMA

1.5 KM
 1.3 KM
 1.6 KM
 2.3 KM

550 M
 900 M
 850 M
 550 M
 700 M

500 M
 650 M
 1.7 KM
 1.3 KM

2.1 KM
 600 M
 170 M
 800 M
 500 M

STRUCTURE

- RCC frame structure with standard ISI marks Cement & steel.
- Internal wall will be 4" thick & external Wall will be 6" Thick by fly ash bricks / AAC blocks.

FLOOR FINISH

- Vitrified PGVT flooring 800x1600mm in living room, kitchen, & All bedrooms.
- Anti-skid flooring in the balcony, terrace bathroom & utility area.

KITCHEN

- Granite kitchen platform with stainless steel sink
- 600x1200mm high-quality dado up to slab level
- Provision for R.O. Water purifier.

WASH & UTILITY

- Tiles in utility area & adequate electrical and plumbing points

BATHROOM/ TOILET

- Decorative high-quality tiles up to slab level.
- Sanitary ware in all toilets by jaquar.
- C.P. Fitting in all toilets by jaquar.
- CPVC concealed piping by supreme or equivalent brand.

DOORS & WINDOWS

Door

- Designer laminated main door & bedroom door with Plywood frame provided with premium make lock and fittings.
- Internal bathroom door frame of granite with standard quality.
- Laminated flush door with premium make lock and fittings.

Window

- All windows openings are provided with 3-track aluminium sliding Windows with mosquito net.
- Well-designed S.S. Glass safety railing for balcony.

WALL SURFACE & PAINT

- POP false ceiling in living room.
- Premium emulsion color on walls, ceiling, and weather shield Paint on exterior walls.
- External wall finish with double coat plaster and internal wall Finish with gypsum plaster.

ELECTRICAL

- Sufficient points wiring by polycab and modular switches by Anchor penta or equivalent.
- Provision For geyser and A.C.

TELEVISION & INTERNET

- Convenient provision of WIFI & television points in each flat.

ELEVATOR

- Fully automatic high-speed elevator with mandatory safety Device & battery backup.
- Fully S.S. Cabin in the elevator.

PARKING

- Interlocking Paver-blocks/ tiles of Premium quality
- Allotted car parking for each flat.
- Electric vehicle charging point in the parking area.

SECURITY

- CCTV Camera surveillance in the common area & Parking area
- Video door phone

ROOF TOP AMENITIES

- Terrace Garden
- Seating area
- Yoga & meditation area
- Walkway

Note: All dimensions are brick to brick work. Extra amount will be charged for extra work / alterations.

WALKWAY



YOGA AREA



TERRACE AMENITIES



STAGE



CHAIR SEATING